

# QuikRead go<sup>®</sup> CRP & CRP+Hb

Allow the control to stabilize for **30 minutes at room temperature** before use. Pay attention to the complete tightening of the self-sealing screw-cap.

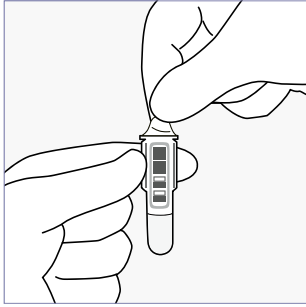

**1** Remove the foil cover from the cuvette. Do not touch the clear flat surfaces in the lower part of the cuvette.

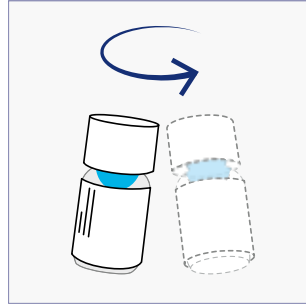

**2** Mix the control vial **gently** by swirling. **Do not shake** to prevent foaming! In case a film appears on top of the vial, wait until it bursts or carefully remove it with a corner of lint-free paper. Keep the bottleneck clean.

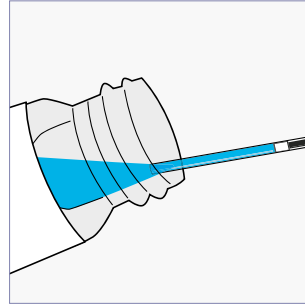

**3** Tilt the control vial slightly. Place the capillary **just below the control surface**. Fill the blue striped capillary with the sample up to the white stopper.

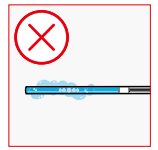
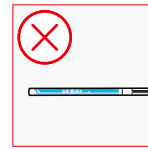
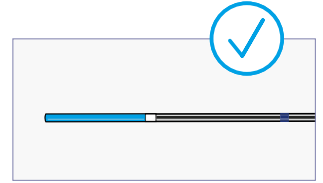

**Note!** Do not place the capillary into the foam. If there are air bubbles on the capillary, discard it and collect a new sample. **Wipe away any residual sample** from the outside of the capillary.

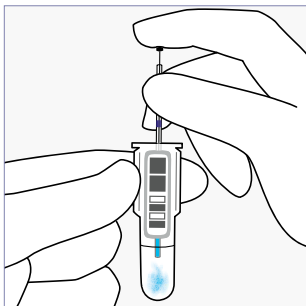

**4** Place the sample (20  $\mu$ l) into the buffer solution in the cuvette and dispense by pressing down the plunger. Make sure that the capillary is completely empty.

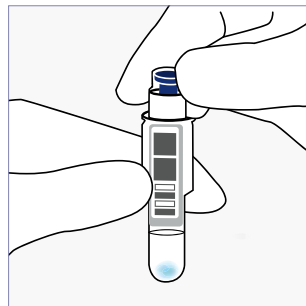

**5** Close the cuvette tightly with the CRP reagent cap. Do not press down the blue inner part of the reagent cap. **Perform the test within 15 minutes.**

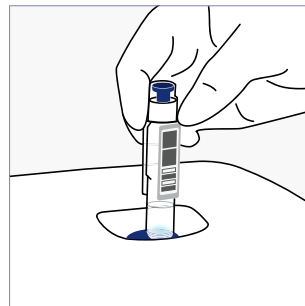

**6** Choose **Quality control** on the display of the QuikRead go Instrument. Insert the cuvette into the measurement well of the instrument. The barcode should be facing you.

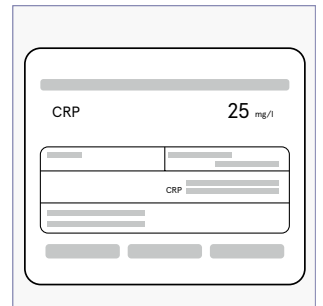

**7** The result appears on the display and the cuvette rises up automatically when the measurement is completed. The acceptance limits of the control are in the labelling.

## Storage

Opened vial is stable for 2 months at 2...8°C.

**Note!** To ensure the self-sealing mechanism of the screw-cap works correctly, it must be screwed until it no longer tightens (2 full rounds). Avoid using the last drops of the control.

# QuikRead go<sup>®</sup> CRP+Hb

Allow the control to stabilize for **30 minutes at room temperature** before use.

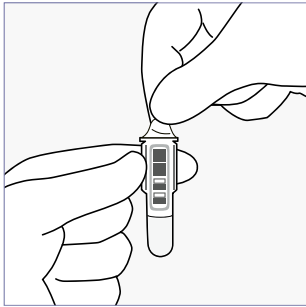

**1** Remove the foil cover from the cuvette. Do not touch the clear flat surfaces in the lower part of the cuvette.

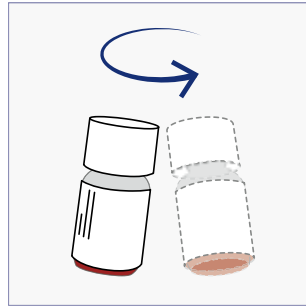

**2** Mix the QuikRead go Hb Control vial **well**. Do not shake. Red blood cells tend to sink to the bottom of the vial. Keep the bottleneck clean.

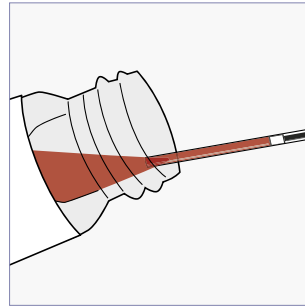

**3** Tilt the control vial slightly. Place the capillary **just below the control surface**. Fill the blue striped capillary with the sample up to the white stopper.

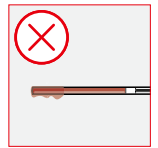
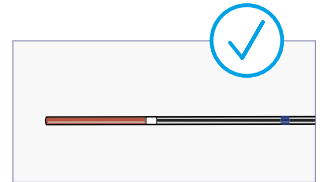

**Note!** Do not place the capillary to the bottom of the vial. If there are air bubbles on the capillary, discard it and collect a new sample. **Wipe away any residual sample** from the outside of the capillary.

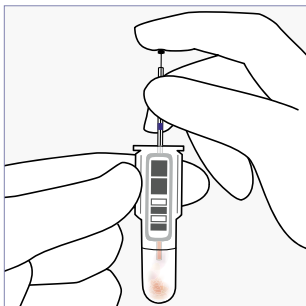

**4** Place the sample (20 µl) into the buffer solution in the cuvette and dispense by pressing down the plunger. Make sure that the capillary is completely empty.

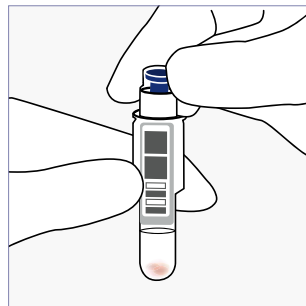

**5** Close the cuvette tightly with the CRP reagent cap. Do not press down the blue inner part of the reagent cap. **Perform the test within 5 minutes.**

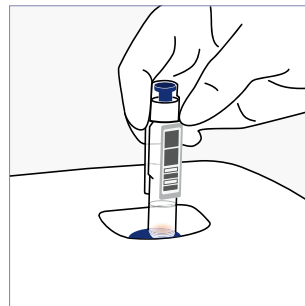

**6** Choose **Quality control** on the display of the QuikRead go Instrument. Insert the cuvette into the measurement well of the instrument. The barcode should be facing you.

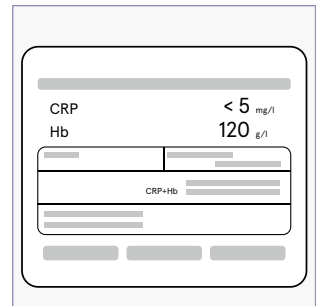

**7** The result appears on the display and the cuvette rises up automatically when the measurement is completed. The acceptance limits of the control are in the labelling.

## Storage

Opened vial is stable for 1 month at 2...8°C.

**Note!** To ensure the self-sealing mechanism of the screw-cap works correctly, it must be screwed until it no longer tightens. Avoid using the last drops of the control.